

M300 SOIL MIXER



Williames

Leading by Innovation



**DUAL AXIAL & ROTATIONAL
MIXING—AUGER GIVES GENTLE &
FAST MIXING ACTION WITHOUT
DAMAGING THE SOIL STRUCTURE**

Williames Pty Limited
A B N 42 004 320 834
103 Butlers Track Warragul
Victoria 3820 Australia
phone: +61 3 5623 5755
fax: +61 3 5623 5165
email: sales@whti.com.au
web: www.williames.com

M300 SOIL MIXER



Williames

Leading by Innovation



WITH SIDE RAMP ACCESS

WILLIAMES M300 SOIL MIXER gives a gentle and fast mixing action without damaging the structure of the mix ingredients.

FEATURES

- Flat section helix auger ensure minimum damage to the soil mix
- Safety mesh cover
- 3 phase motor
- Robust construction means low maintenance and high productivity

OPTIONS

- Twin or single Bin Rotator
- Single phase motor with inverter
- Replacement liner
- Castor wheels
- Adjustable timer for automatic turn off
- Air or electronically operated discharge door
- Walkway
- Soil Elevator

DIMENSIONS: (APPROXIMATE)

M300 cu/m

	METRIC	IMPERIAL
L:	3150	124"
W:	1350	53"
W: (With Sidewalk)	1430	56"
H:	2260	89"

Williames Pty Limited
A B N 42 004 320 834
103 Butlers Track Warragul
Victoria 3820 Australia
phone: +61 3 5623 5755
fax: +61 3 5623 5165
email: sales@whiti.com.au
web: www.williames.com

M300 SOIL MIXER



Williams

Leading by Innovation



MESH GUARD BOLTED SHUT & LARGE SPROCKET FOR CHAIN DRIVE

M300 SOIL MIXER



Williams

Leading by Innovation

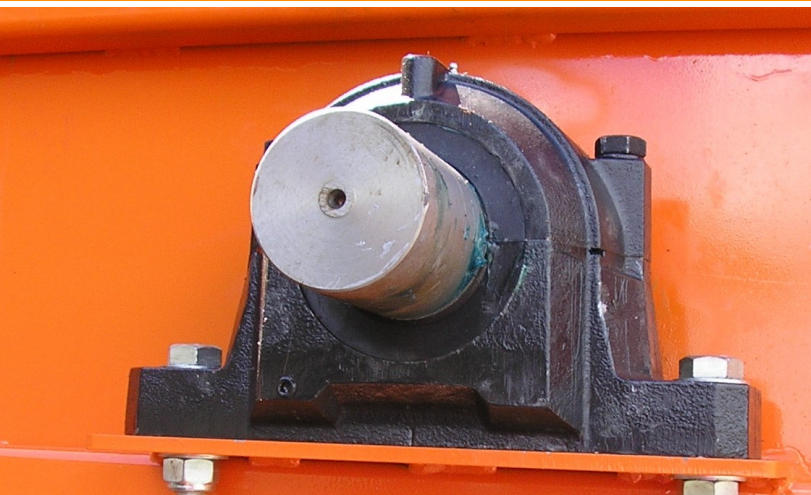

AUGER SHAFT BEARING



DRIVEN SHAFT SPROCKET



GEAR BOX + DRIVE SPROCKET & CHAIN



INBOARD TRANSMISSION DRIVE



BIG BIN TIPPER

M300 SOIL MIXER



Williames

Leading by Innovation

REMOVE ALL BURR'S AND SHARP EDGES.

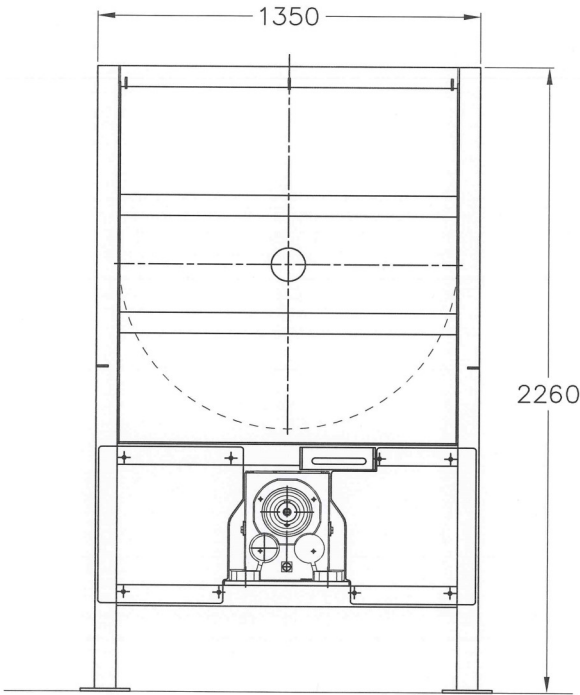
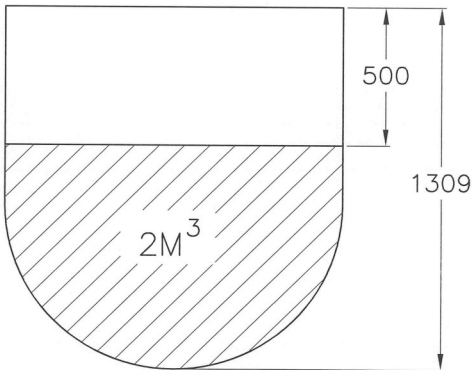

M300 MIXER END VIEW

REVISIONS:

USED ON	QTY
---------	-----

ITEM	PART No	DESCRIPTION	QTY
UNAUTHORISED COPYING OF THIS DRAWING IS STRICTLY PROHIBITED			
A3	DRG No.	COMP-003	REV
MAT'L			QTY: OFF
DRAWN: G.B		DATE: 4.11.15	
CHK'D:		WEIGHT:	
WILLIAMES PTY LTD		SCALE: 1:10	GEN. TOL: ±0.125
BUTLERS TRACK WARRACRU, VICTORIA, AUSTRALIA 3820			